

PROVINCIA DI BIELLA  
**COMUNE DI BIELLA**

OGGETTO  
 Impianto fisso di estinzione incendi con idranti a servizio del  
 fabbricato di proprietà Apra Piemonte all'interno del  
 comprensorio "Città studi di Biella"  
**- PROGETTO DEFINITIVO -**

DOCUMENTO  
**PLANIMETRIA GENERALE**





PROPRIETA'  
  
 Apra Piemonte  
 Progettista Impianti  
 Apra Piemonte  
 Ing. Franco SERENO  
 Via C. Colombo n. 10 - 10128 TORINO  
 tel. 011/8190135  
 e-mail: studio.sereno@beaol.it

Rip. Dottor Mauro PORTA - Apra Piemonte

| NO. | DESCRIZIONE         | DATA       | CMR | VERB. |
|-----|---------------------|------------|-----|-------|
| 1   | PROGETTO DEFINITIVO | 14/11/2019 | MB  | F.S.  |
| 2   |                     |            |     |       |
| 3   |                     |            |     |       |
| 4   |                     |            |     |       |
| 5   |                     |            |     |       |
| 6   |                     |            |     |       |

SCALA  
 1/1000

TAVOLA  
**1**

| LEGENDA  |
|--|
|  IDRANTE UNI 45   |
|  GRUPPO ATTACCO MOTOROMPA VVF IN CASSETTA ESTERNA   |
|  DISPERTE TIPO DN 40  |
|  TUBO IN ACCIAIO BITUMINATO DN 80 NEI TRATTI INTERRATI O IN POLIETILENE AD ALTA DENSITA' CON TUBO Camicia DN 80 |
|  TUBO IN ACCIAIO S.S. NEI TRATTI A VISTA DN 45  |

**PIANTA PIANO TERRA - scala 1:100 -**

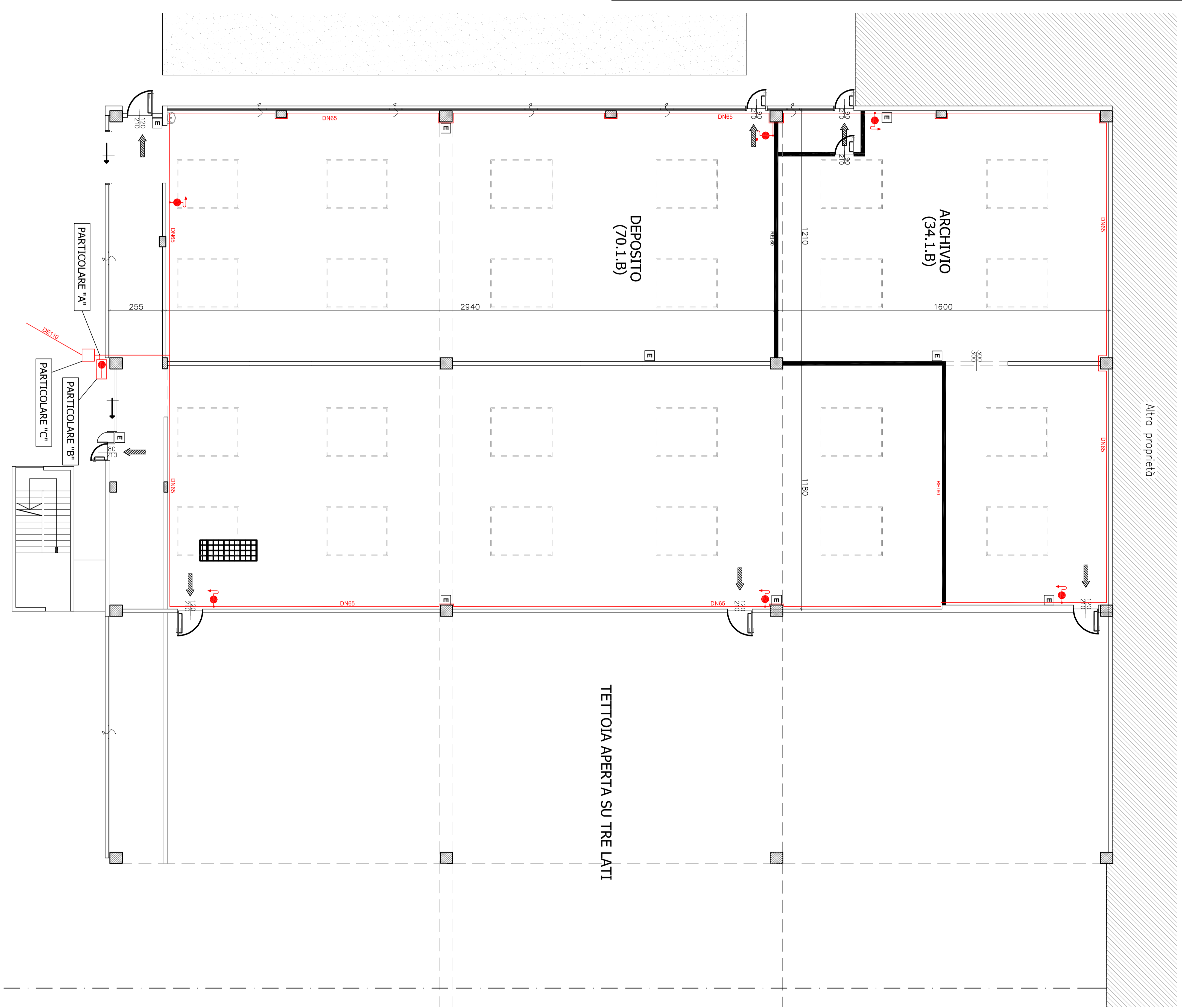

**SEZIONE AA' - scala 1:100 -**

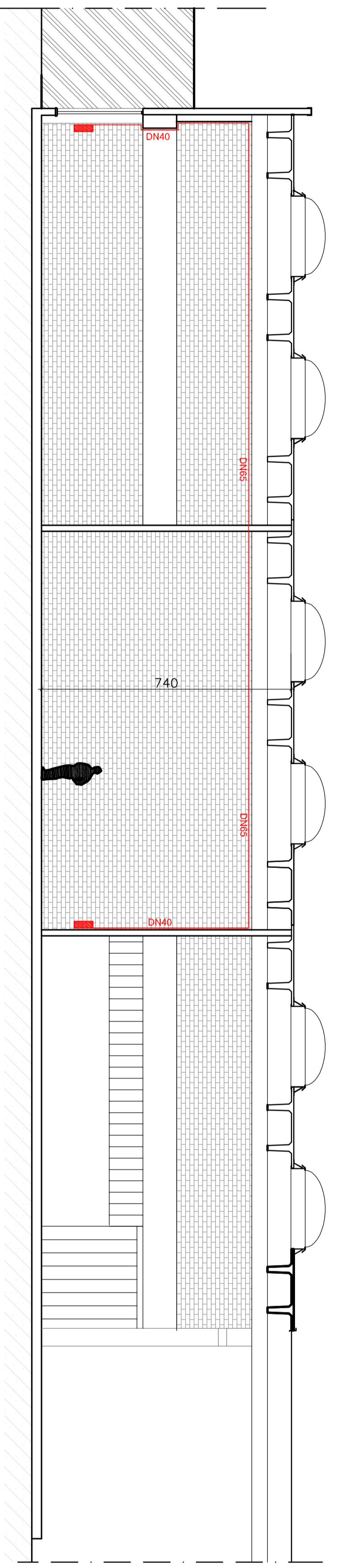

**PARTICOLARE "A"**  
 SCAVO SEZIONE TIPO Scala 1:10

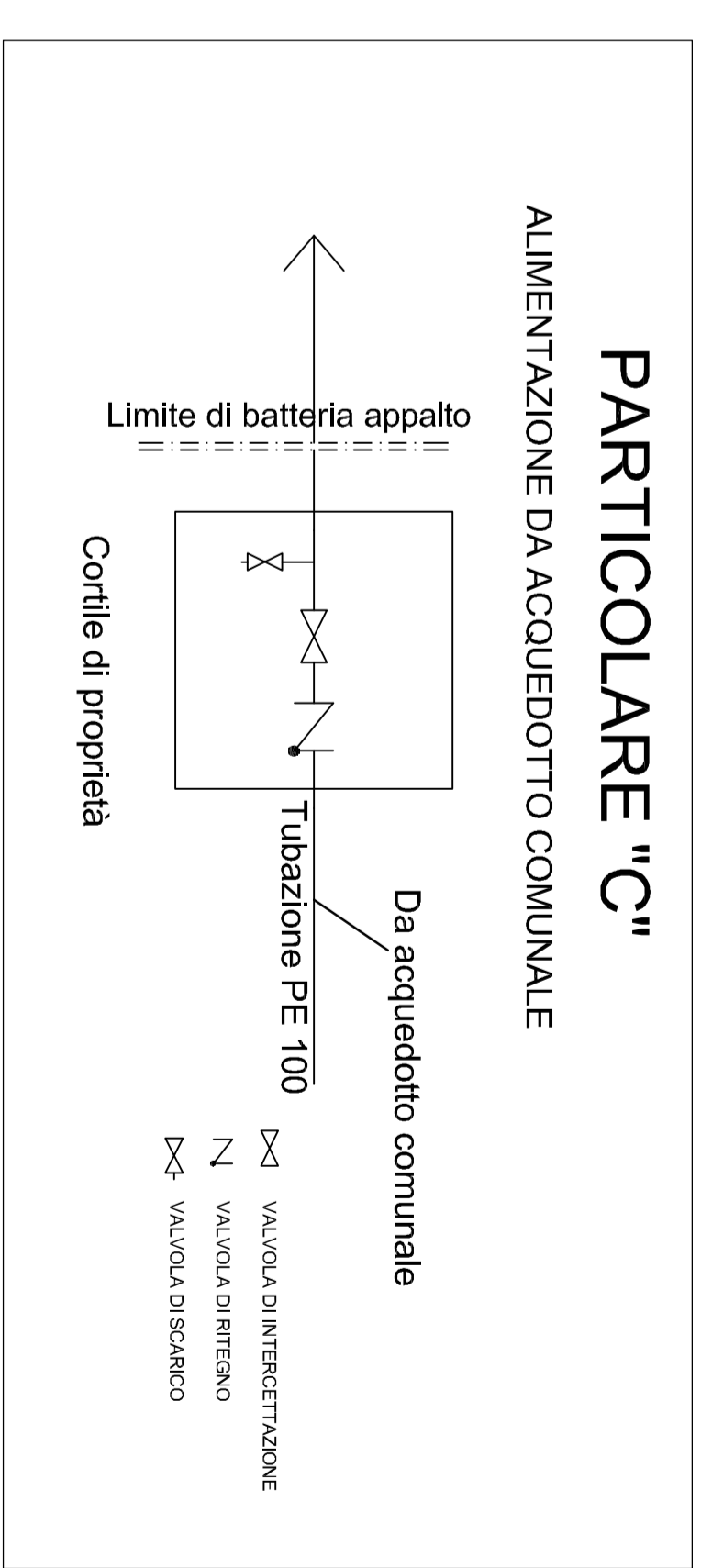
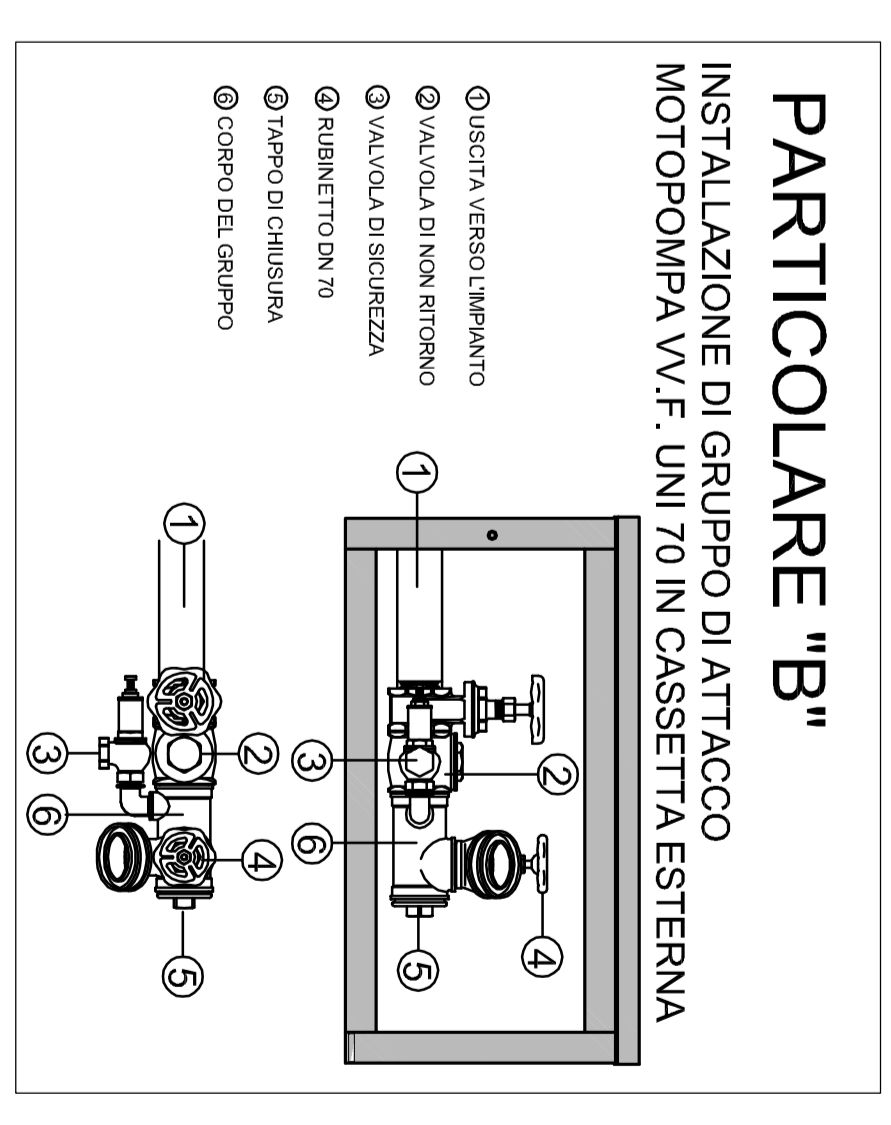
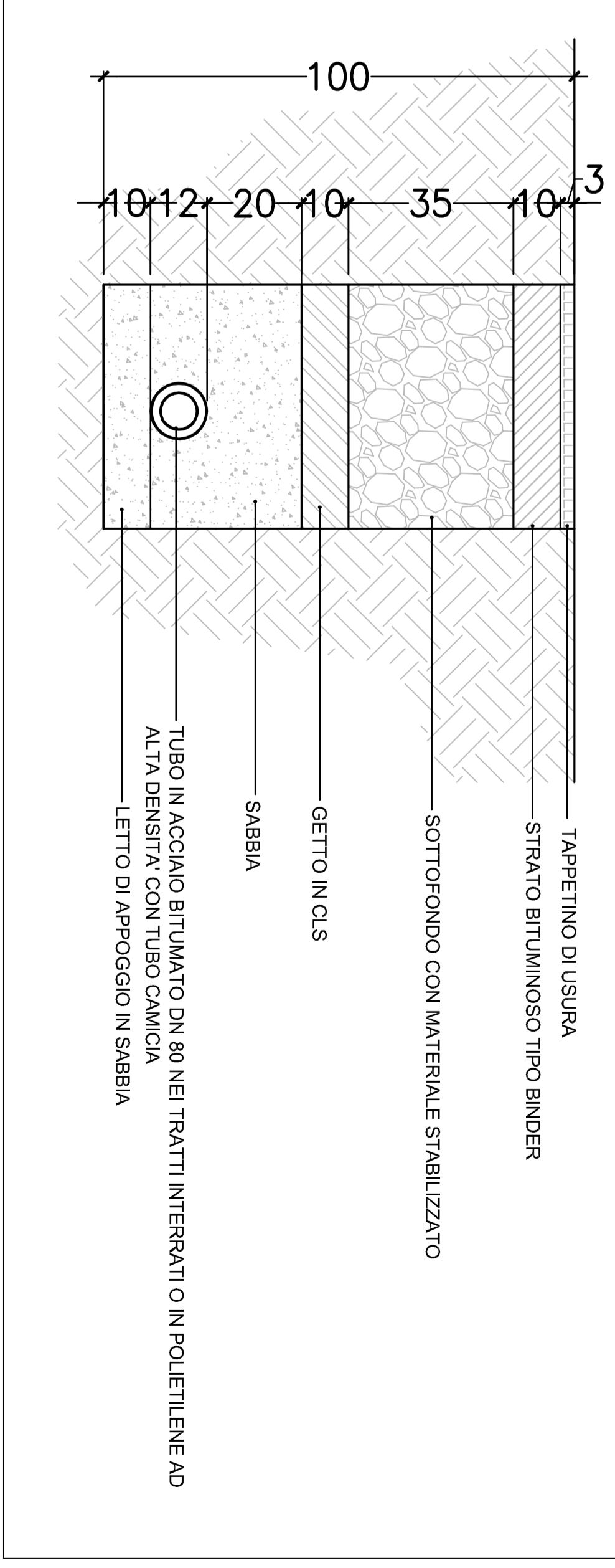

**PLANIMETRIA GENERALE - scala 1:1000 -**

