

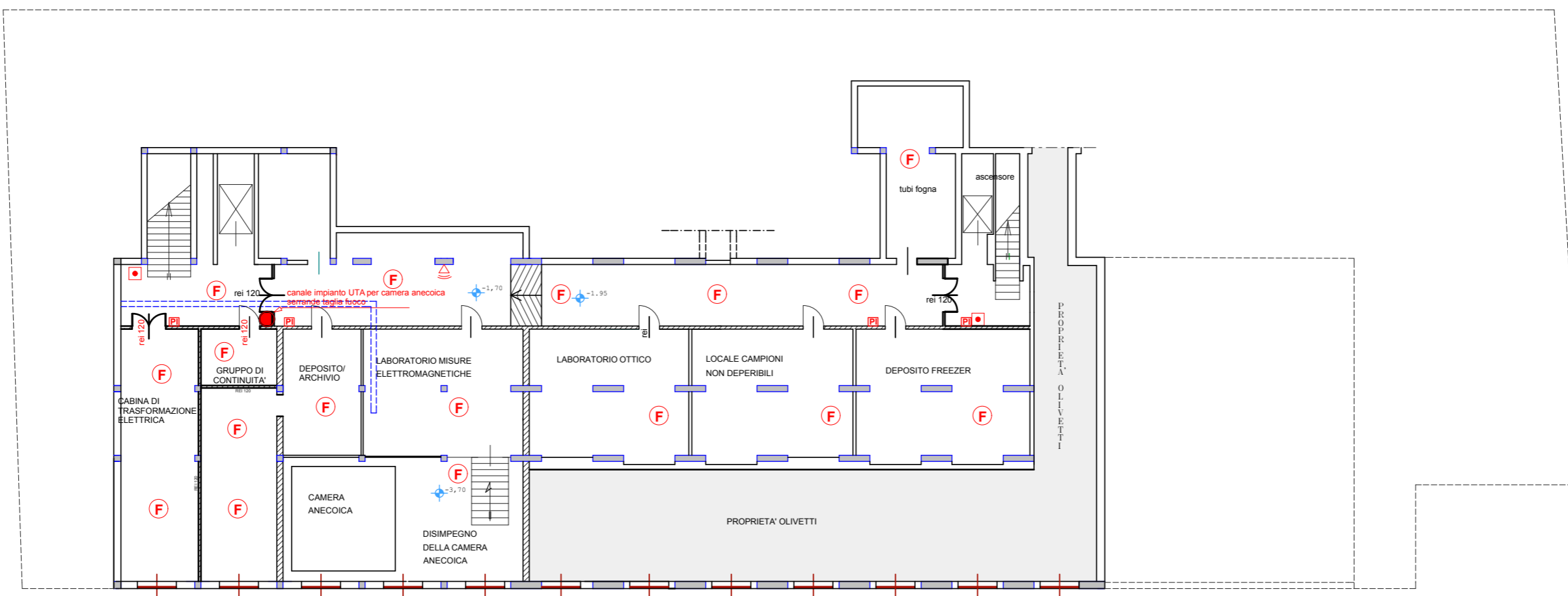





PIANO SEMINTERRATO



LEGENDA
dotazione antincendio esistente:

	RILEVATORE DI FUMO
	RILEVATORE DI GAS
	SIRENA
	PULSANTE ALLARME
	PANNELLO INCENDIO
	PANNELLO FUGHE GAS
	SERRANDA TAGLIAFUOCO